

fullplay Step-by-Step Instructions for Quick Setup

1 Safety First

Please read the safety instructions in Section 4-6 of your User's Manual

2 What's in the Box

Read about more in Section x-x of your User's Manual

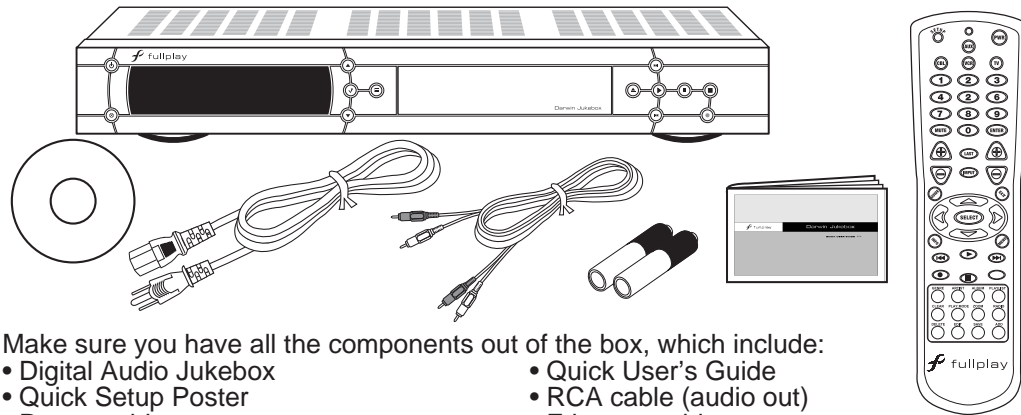

Make sure you have all the components out of the box, which include:

- Digital Audio Jukebox
- Quick Setup Poster
- Power cable
- Remote control and two AA batteries
- Warranty registration card / CD subscription card
- Quick User's Guide
- RCA cable (audio out)
- Ethernet cable
- Software update CD-ROM

3 Hooking Up the Digital Jukebox

Read about more in Section x-x of your User's Manual

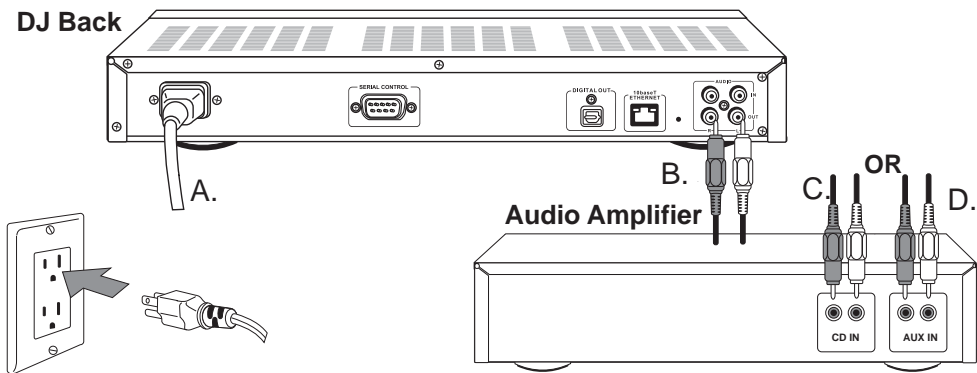

Power: Connect the power cable (A) to the DJ and a power source.

Audio Amplifier/Receiver: Next, connect your DJ to an amplifier or receiver. The RCA cable provided (B) is used to connect the **output** from the DJ to the several **inputs** that can be used for this product. We recommend CD input source (C) or AUX input source (D).

4 Powering Up your Digital Jukebox

Read about more in Section x-x of your User's Manual

The power button for the DJ is located on the front of the device, in the top left hand corner. When you press the power button, the DJ's LCD screen will wake up with the FullPlay logo. It may take a moment before the media player screen displays.

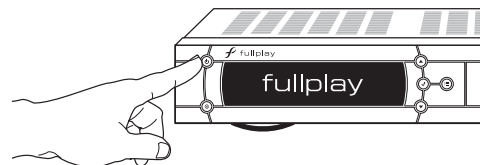

5 Playing a CD

Read about more in Section x-x of your User's Manual

Open the CD tray by pressing on the front of the DJ. Place a CD in the tray.

Press or to insert the CD.

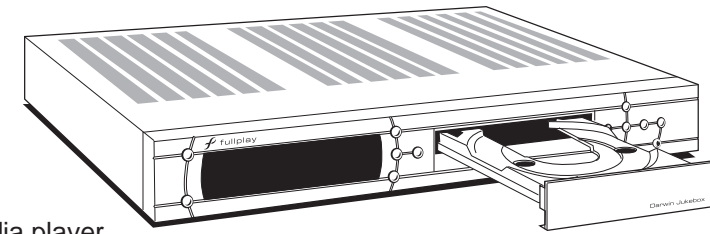
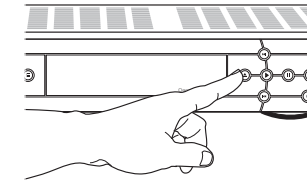

Notice the display screen on the front of the device (called the media player screen). Each time you put in a CD, the DJ will search its database for the album information (artist, song titles, etc.). The system messages located at the bottom of the display screen provide details on what the device is doing.

6 Recording from a CD

Read about more in Section x-x of your User's Manual

With a CD in the tray, notice the green light on the lower right corner of the DJ. This is the record button and it will automatically illuminate with a green light if the CD has content that can be recorded to local storage.

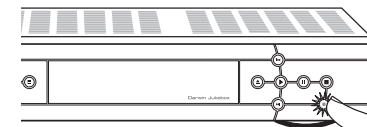

Press while playing to start the standard recording mode. Pressing while stopped will fast record a single track. Holding at any time will fast record the entire CD. Notice that the media player screen will display the recording progress and the record button will glow red.

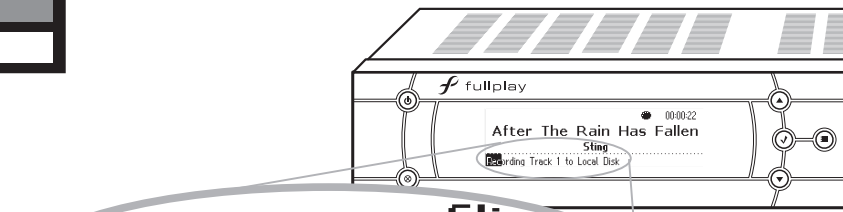

Recording Track 1 to Local Disk

Recording Track 1 to Local Disk

7 View the Recorded Music on Your Hard Drive

Read about more in Section x-x of your Quick User's Guide

If you wish, remove the CD when you've finished recording.

Press on your remote control. Use the and navigation arrows on your remote control to scroll to Music Libraries, press on your remote control. Scroll to Hard Drive, press to view your newly recorded content.

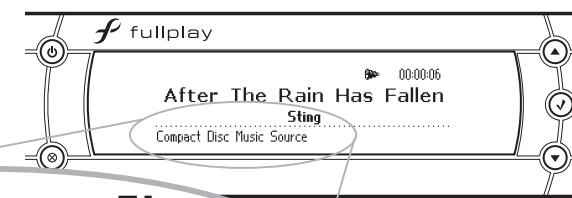

Compact Disc Music Source

Local Music Source

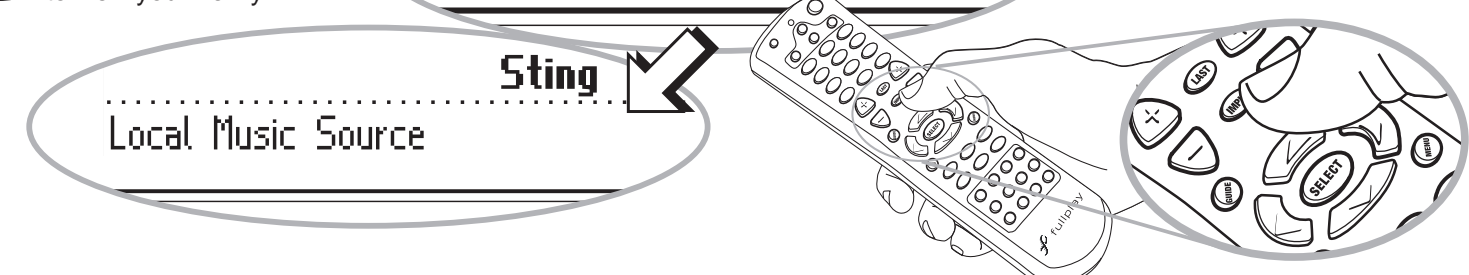

! We recommend that you read your Quick User's Guide for useful tips, definitions, warnings, and other reference materials about your new DJ.

If you have questions or need any additional information, we are available to help. Please do not return to your retailer, contact FullPlay directly.

- Online: www.fullplaymedia.com
- Email: derekd@fullplaymedia.com
- Phone: 425-289-0321 (office hours 8-5 PST)